

FOOD TRUCK RODEO!

FRIDAY OCT. 28TH

DESSERTS

ICE CREAM

POPSICLES

POPCORN

WAFFLES

DIPPED CHEESECAKE

DOUGHNUTS

SHAVED ICE

SLUSHIES

LEMONADE



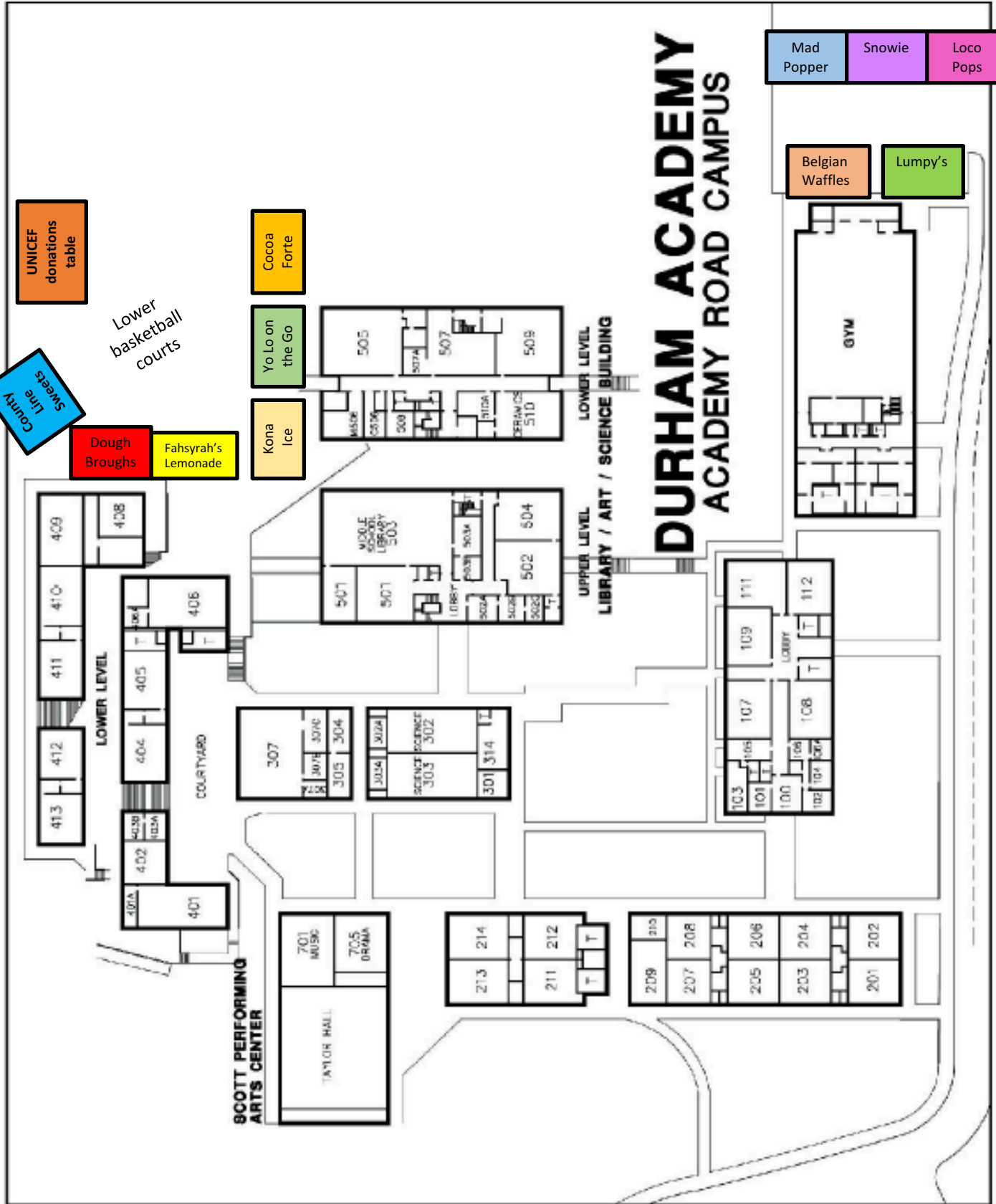

Lumpy's

Ice Cream

Flavors:

Strawberry

Chocolate

Vanilla

Butter Pecan

And two specialties to be determined

Prices:

Single Lump \$3 in a Waffle Cone \$4

Double Lump \$7 in a Waffle Cone \$8



Local Yogurt



\$5 a yogurt with two toppings

Flavors

Chocolate*Vanilla*Pumpkin
Pomegranate Raspberry Sorbet

Toppings

strawberries*mango
Hershey's syrup* Caramel sauce
whip cream*almonds*peanuts
gummie bears*sprinkles*Reece's
M+M's*oreos*chocolate rocks*granola*graham
cracker dust



Prices

Pops-\$3

Flavors

Many flavors to choose from!

The Mad Popper



Flavors

- Halloween Mix (grape, green apple, orange, black cherry, & classic)
 - Caramel
 - Cheddar blend
- TMP (The Mad Popper Blend)



Popcorn cones
\$2.25 each
(including tax)





The Sweet Inspirations

<i>Liege Classic</i>	The hidden treasure of Belgium, soft and chewy, with pearls of sugar... It's deliciously naked, with a caramelized sugar crust! <i>Want some for later? Liege is still perfect 2 days after purchase</i>	\$4
<i>Choco-Waffle</i>	A Liege waffle filled with 2 melting chocolate sticks	\$5
<i>Banana Split</i>	Banana, homemade whipped cream, hot Belgian chocolate fudge, walnuts	\$8
<i>Sweet Strawberry</i>	Strawberries, powdered sugar, homemade whipped cream <i>Add hot Belgian chocolate fudge and have it à la mode</i>	\$6 + \$1
<i>Guilty Pleasure</i>	Nutella, homemade whipped cream, hot Belgian chocolate fudge, walnuts	\$8
<i>Canadian Twist</i>	Maple syrup, cinnamon sugar	\$5
<i>Cinnawaffle</i>	Speculoos, homemade whipped cream, cinnamon sugar	\$6
<i>Oh la la!</i>	Nutella, strawberries, banana, homemade whipped cream, hot Belgian chocolate fudge	\$10
<i>WPBJ</i>	Peanut butter, Belgian made strawberry jam	\$6
<i>Pom'Caramel</i>	Apples, caramel sauce, cinnamon sugar	\$6
<i>Papa Smurf</i>	Strawberries, plain yogurt, honey	\$7
	<i>Add a scoop of Vanilla ice cream and have your waffle à la mode</i>	+ \$1

Make your own

Step 1: Choose a Liege or a Choco-Waffle

Step 2: Add your Sidekicks

Complimentary: Powdered sugar - Cinnamon sugar - Cocoa powder

Extras: \$1 each

<i>Strawberries</i>	<i>Nutella</i>	<i>Honey</i>	<i>Homemade Whipped Cream</i>	
<i>Bananas</i>	<i>Speculoos</i>	<i>Maple Syrup</i>	<i>Vanilla Ice Cream</i>	
<i>Apples</i>	<i>Peanut Butter</i>	<i>Hot Belgian Chocolate Fudge</i>	<i>Plain Yogurt</i>	
<i>Walnuts</i>	<i>Strawberry jam</i>	<i>Caramel Sauce</i>	<i>Bacon</i>	\$2

Cocoa Forte

Chocolate Dipped Cheesecakes

\$5.00

Slice

Cocoa Classic



Milk Chocolate dip,
choice of drizzle

Cocoa Chocolate Peanut Butter



Chocolate peanut butter dip,
crushed nuts, caramel &
chocolate drizzle

DRIZZLES

chocolate, caramel,
raspberry, strawberry,
blackberry,
white chocolate

Cocoa Birthday



Vanilla birthday dip,
rainbow sprinkles



Flavors

Vanilla

Chocolate

Cinnamon Sugar

Maple Bacon

Apple

Sea Salt Caramel

All of our Doughnuts are \$1.50 each!



Cup Sizes

- ❖ Regular- \$3
- ❖ King- \$4 (comes with a free lei)
- ❖ Kowabunga- \$5 (Color-changing of island rush cup. These are refillable forever. \$3 per refill)

Flavors

Tigers Blood*Green Apple*Blue Raspberry*
Monkey Business*Sour Grape
Mystery Flavor*Island Rush
Cherry*Mango
Pina Colada



Hawaiian shaved Ice

-Regular \$3

-Jumbo \$5

Lemonade Slushies

-Regular \$4

-Large \$5

Fahsyrah's Lemonade

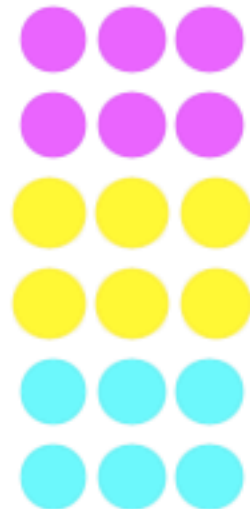
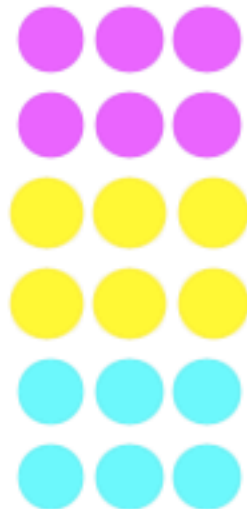

Sizes:

- 16 oz.
- 24 oz.

Prices:

- 16 oz: \$3
- 24 oz: \$5

County Line Sweets

Menu
coming
soon...

